

**HIGH PERFORMANCE ANTISLIP ANTIWEAR
CAST METAL TACTILE PLATE**



DATA SHEET: TP1/200®	
DATE: Oct 2013	ISSUE: 2
ITEM: Floor Plate	

Item: AATi™ Type TP1/200® Cast Metal Tactile Plate with Silicon Carbide Granules cast into the metal matrix of the wearing surface.

Application: For heavily used public stairways and Landing areas. These plates are purpose made in one or more pieces to suit the required stair width and as sets of four strips to give the required 800mm of cover as per BS 8300:2009.

Materials: Nickel Bronze, Gunmetal, Aluminium.

Typical Spec: AATi Cast (Nickel Bronze/Gunmetal/Aluminium) Tactile plate, type ref - TP1/200® in sets of 4 strips @ [] mm long to cover a total area of 800mm x []mm, each piece drilled and countersunk for fixing.

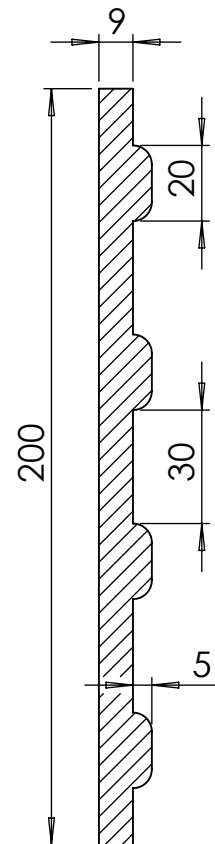
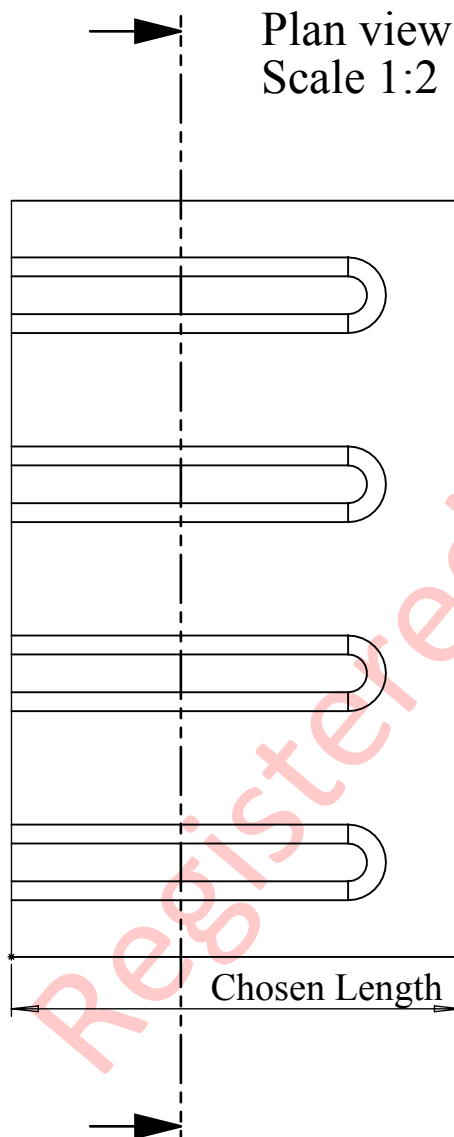
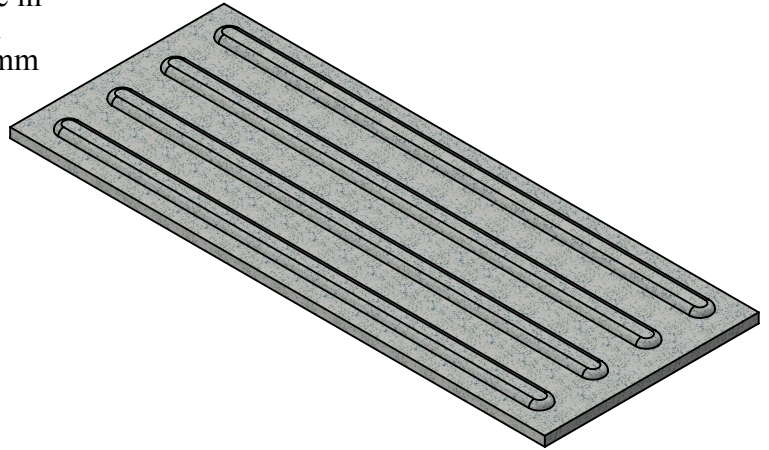

Section view scale 1:2

Special attention should be given to installation & drainage of this product. For further advice please speak to a member of AATi's technical department. Dimensions shown are nominal and subject to AATi manufacturing tolerances.