

AATi Recommended Installation

Guidelines for fixing onto steel.



DATE	14/06/16
REVISION	3

1. Check surface is sound and level.
2. Make good any worn or damaged areas or uneven surfaces with appropriate filler.
3. Position AATi nosing onto step in correct position.
4. Spot through holes using drill bit.
5. Lift off nosing and drill pilot holes through spotted positions using a 7mm drill bit.
6. Clean out dust/dirt or other contaminants from hole.
7. Apply Rubberoid Hyload Original Damp Proof Course (DPC) to cover the entire internal face of the nosing and insert Sika water stop bar (or similar approved).
8. Place nosing back into position on step ensuring it is fully supported and allow a sufficient fall on the nosing to encourage water to drain to the rear.
9. Fix by inserting appropriate length (30mm) M6 stainless steel countersunk pozi machine screw and tighten to form a secure fixing.
10. Finally once nosing is secured in correct position the nyloc nut can be tack welded to the underside of the fabricated stair.

Fig 1. Section view of fixing detail for SN93/SL3/280RT

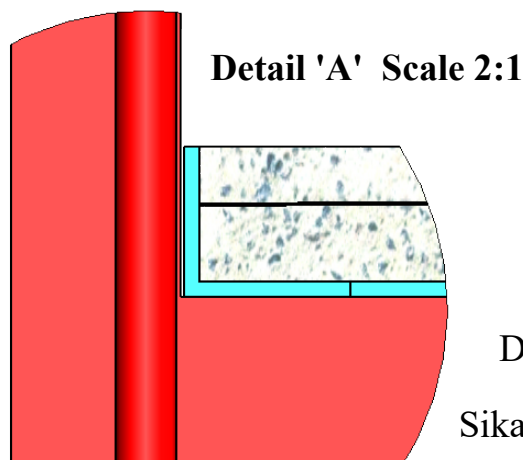
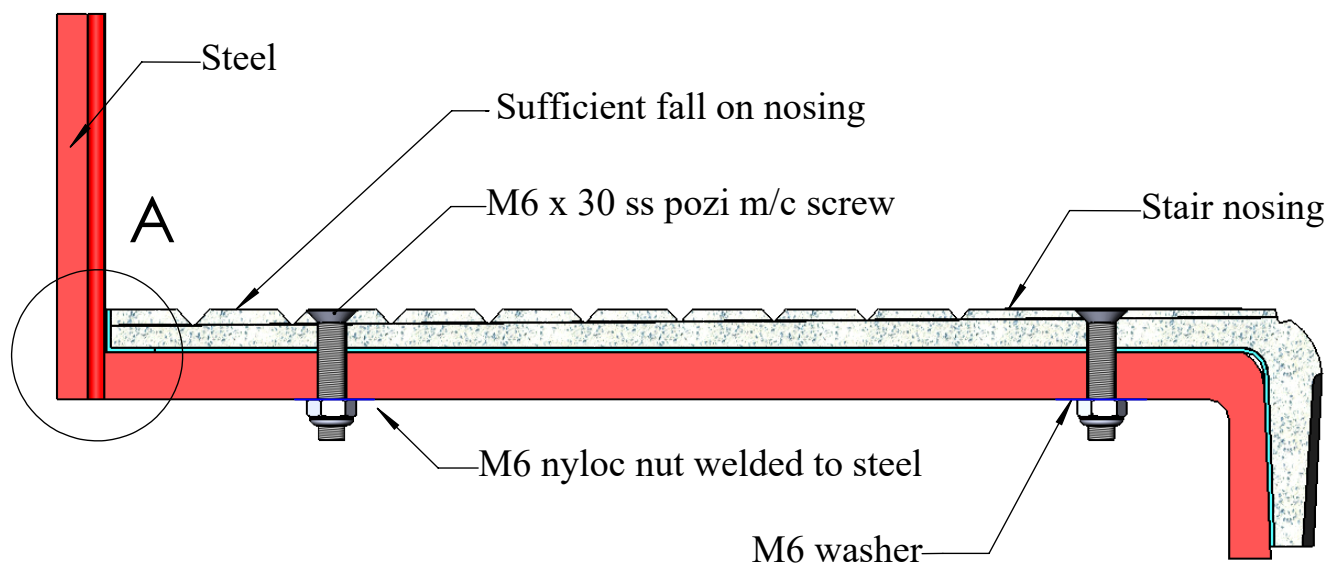

Weep hole

DPC
Sika water stop bar

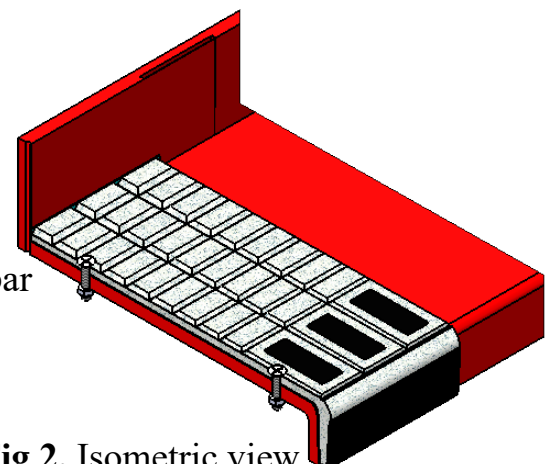

Fig 2. Isometric view of fixing assembly

NB: Nosing's must be installed in such a way that standing water is omitted. Please refer to AATi O&M Manual
All AATi products are subject to our manufacturing tolerances and should be taken into consideration when installing